



**Acora Acoustics**  
**-HEAR THE TRUTH-**  
Owner's Manual  
SRC-1  
Floorstanding Speaker





*Thank you from Valerio Cora*

Thank you for selecting the SRC-1 Floorstanding Loudspeaker by Acora Acoustics. My team and I have designed and built the SRC-1 with precision using premium parts and a unique granite enclosure, hand built by stone artisans to bring you closer to your music and that you may “- **HEAR THE TRUTH** -”.

Please read through this manual to ensure you get the most from your Acora Acoustics SRC-1s.

As the SRC-1 is constructed of granite, it is quite heavy and caution should be used when placing or re-positioning by a single person. If needed, seek qualified assistance such as your Acora Acoustics dealer or consultant. Do not grasp the SRC-1 by the drivers or the rear port tube.

We suggest the following:

- 1) Thoroughly read through this manual
- 2) Follow the unpacking instructions

Each Acora Acoustics product has been inspected and packaged with care. Should you have questions or comments - please feel free to reach out to our special owner specific email address - [acora-owner@acoraacoustics.com](mailto:acora-owner@acoraacoustics.com). We will reply ASAP

*Enjoy!*

*Valerio Cora*



# Unpacking and Initial Placement

Each Acora Acoustics loudspeaker has been inspected and packaged with pride. Please verify that both crates are in good condition and the serial numbers are consecutive.

We do not suggest unpacking the SRC-1 alone. Have your dealer or consultant perform or at least assist with this process. The SRC-1 is quite heavy and should not be moved without qualified assistance.

- 1) Remove the speaker from the carton by removing the 4 clips at the bottom edges of the carton (see below), then lift the top straight up and off. Fold down the side of the bottom tray at the front of the speaker. Place a 2-wheeler or dolly under the front of the speaker. Slowly tilt towards you until the front of the speaker is perpendicular to the floor and gently roll it out of the tray and into its rough position.
- 2) Use caution not to grasp the speaker near the drivers as you could damage them.
- 3) Visually inspect the speaker for any transit damage.
- 4) Place the speakers on level flooring and use the furniture sliders as you position them.
- 5) For initial positioning, place the speakers firing perpendicular from the rear wall, roughly the same distance between them as they are to the main listening position (if you sit 12' back from them, start with the speakers 12' apart if possible unless side walls prevent it) Typically, the speakers will image best when not towed in.
- 6) Connect your speakers to your amplifier and perform initial listening tests. This very well may not be their final position.
- 7) Once you believe placement is set, remove the furniture sliders. You can use the spikes to ensure the speakers are level. If the speakers are not level, unscrew and remove the spike cap. This will expose the top of the spike. Using the supplied tool, adjust the spikes until the speaker is level and stable (it should not rock from back to front or side to side).
- 8) Once level and stable, replace the spike caps and tighten them.

Please refer to the supplied separate sheet on the footers to select the right configuration for your floor.

Listen and enjoy. You may find over time that you want to re-adjust speaker placement, again, please do not attempt this alone.

1) Pinch the two vertical ribs so the bottom swings out from the base.

2) Swing the paddle up and pull entire clip out when it becomes free.

3) Save these clips for future use

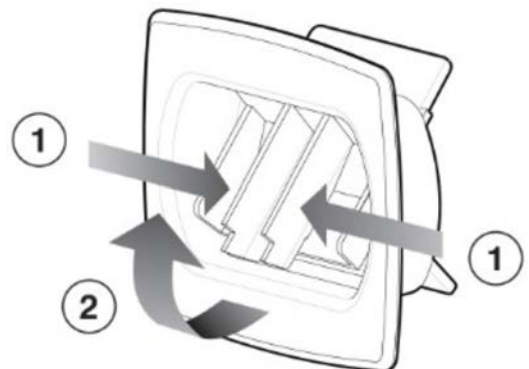



## Making Connections

Any time you are making changes to the speaker connections to your amplifier, that amplifier should be switched OFF. Please double check all connections before turning the amplifier back on. Failing to do this could result in damage to your amplifier.

The connection block on the SRC-1 will accommodate bare wire, spade lugs, or banana terminations. As you face the back of the speaker, the terminal on your left is the - NEG connector and the right is the + POS. Typically speaker cables will also be designated by RED and BLACK. Regardless of color, you should be sure to match the same color to the "+" and "-" at both the speaker and at the amplifier connections. Insuring the correct polarity (or phase) will provide optimum sound quality from your system. Incorrect (out of phase) wiring would cause a loss of bass and unclear center imaging.

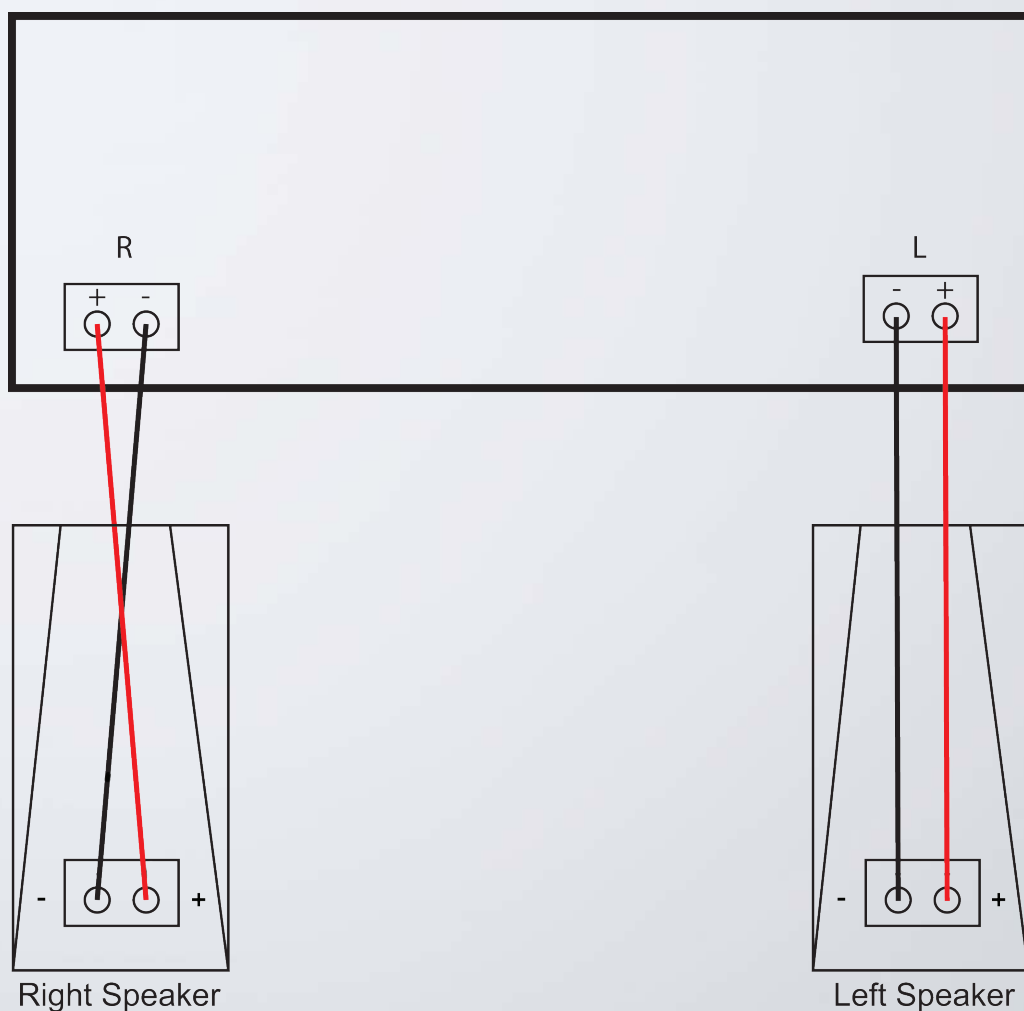

# Amplifier Requirements and Power Handling

While conditions vary widely, such as room size, preferred listening level, and content being listened to, these basic guidelines may be of value when mating the SRC-1s with the right amplifier for you. Remember, it is more likely to damage a speaker by using an amplifier with insufficient power required to drive the speakers to a desired volume, than it is to damage the speakers with an excess of power. An amplifier being driven past its capabilities will output higher distortion when driven past its rating (clipping). This generates more heat and is typically what causes damage to a speaker.

We recommend amplifiers between 10 watts per channel, and 250 watts per channel.





# SRC-1 Specifications

Type - 2 Way Bass Reflex

Woofer - 7" Sandwich Paper Cone

Tweeter - 1" Soft Dome Ring Radiator

Nominal impedance - 8 ohm

Suggested amplifier range - 10w - 250w

Sensitivity - 90.5 1w/1m

Frequency Range - 29Hz - 30KHz

Enclosure - High Polish Black Granite 3cm

Exterior dimensions - 14" x 18" x 43"

Weight - 246lbs each



# Caring for your Acora Acoustics

The SRC-1 granite enclosures require minimal care. We have included a small bottle of granite polish and a polishing chamois. These will restore the gloss and luster to your speakers' enclosure, however it will cause damage your speakers' drivers. Do NOT spray polish on the drivers, do NOT use a damp cloth of any kind on the drivers themselves. Damage to the drivers due to moisture or polish would affect the sound quality and would not qualify for warranty repairs. If there are any questions regarding the care of your speakers, please contact your dealer, or the Acora factory.

**(DO NOT POLISH INSIDE THESE CIRCLES)**



Please, *Enjoy!*



# Acora Acoustics

## -HEAR THE TRUTH-

165 Milner Ave  
Scarborough, ON, Canada  
M1S 4G7  
(647) 812-3933  
[info@acoraacoustics.com](mailto:info@acoraacoustics.com)